

Experience Life in Santa Fe

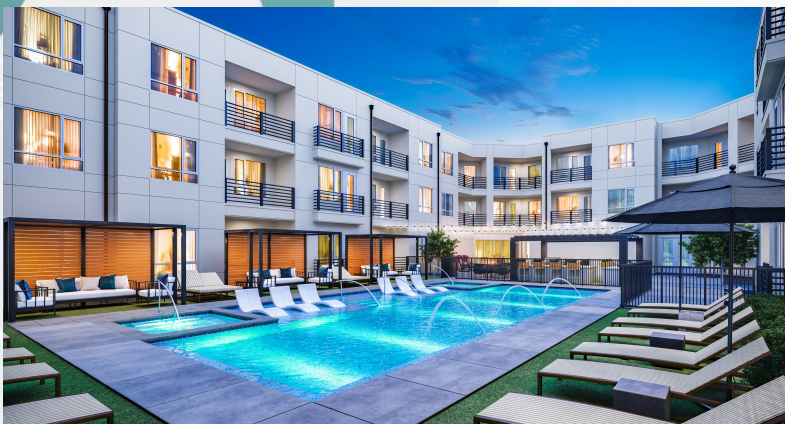

Workforce Housing

Thank you for your interest in applying to live at Casa Siena! In addition to our market rate apartment homes at Casa Siena, a portion of our apartment homes in this community have been reserved for moderate to middle income, critical workforce such as teachers, nurses, first responders, City and County Staff, and other workers. The workforce housing at Casa Siena enables these essential workers to live in the community where they work, avoid a lengthy commute and spend more time with family.



Experience Life in Santa Fe



QUALIFICATION REQUIREMENTS

Any applicant or household living in one of these workforce apartment homes can earn up to the following annual incomes:

- 1- person household - up to \$54,960
- 2- person household - up to \$62,800
- 3- person household - up to \$70,640
- 4- person household - up to \$78,480
- 5- person household - up to \$84,800

*Provided from Housing Authority as of 2024

Applicants must collectively have income in an amount not less than three times the rental rate. We obtain a credit report on each applicant. Our credit reporting agency evaluates credit (which may include rent payment history) as an indicator of future rent payment performance. An unsatisfactory finding will result in the requirement of an additional deposit or denial. Applicants are responsible for ensuring their credit history is accurate.

We obtain a criminal background check on each applicant who will reside in the apartment home. It is possible your application will be denied due to criminal convictions.



Experience Life in Santa Fe



Application Process

- A complete application for every household member 18 years of age and older is required;
- Copy of Non-expired government issue ID - Driver's license, state identification card or passport for everyone 18 years plus.

Income Verification; Anyone living in the home earning income must provide proof of income.

- Three most recent and consecutive checking/saving bank statements
- Six weeks of most recent paycheck stubs
- Most recent two years of Federal Tax Returns

- 1 Bedroom can occupy up to 3 persons
- 2 Bedroom can occupy up to 5 persons
- Occupants are determined by each person living in the home regardless of age.

